

E-book Instructions for Bristol Students & Staff

Load e-books onto your Kindle Black/White E-reader*

*If you have a Kindle Fire, follow the instructions for loading e-books onto a tablet.

1. On a computer or Chromebook, log in to Amazon.com:
 - a. For Kindles: You must log into your (or your parent's) Amazon.com account.
2. In a different tab, go to Wisconsin Schools Digital Library Consortium OverDrive site at <http://wsdlc.lib.overdrive.com>.
 - a. Sign in. Username = lastname.fir (example: smith.joh)
Password = AR/STAR/Destiny/Typing Pal password
 - b. Search or browse to find an e-book to read. Click book cover for more information.
 - c. Click **Borrow > Go to Checkouts > Read now with Kindle**.

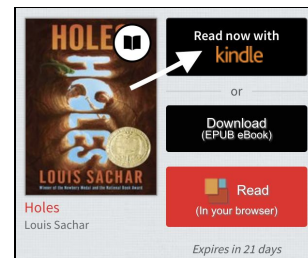

3. At Amazon.com, click **Get library book**.
4. Go to the Kindle: Go to menu on top of screen > click **Sync My Kindle**.

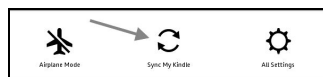
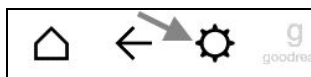

5. The e-book will automatically be returned at the end of its lending period.



Load e-books onto your Chromebook or computer

1. Using your student Chromebook, go to Wisconsin Schools Digital Library Consortium OverDrive site at <http://wsdlc.lib.overdrive.com>.
 - a. Sign in. Username = lastname.fir
Password: AR/STAR/Destiny password
 - b. Search or browse to find an e-book to read. Click book cover for more information.
 - c. Click **Borrow > Go to Checkouts > Read (in your browser)**

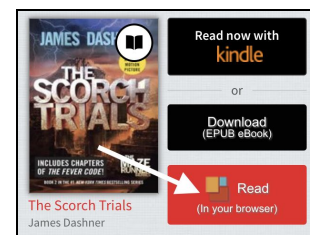

2. You are now in a new tab, with the book open. You can stop here or...
3. You can download the book for offline access on your personal device and bookmark the book in the browser:
 - a. Click the screen to open the menu. Click the three lines in the upper right corner. Click **Offline Access > Start Download > Done**.
 - a. Right click the bookmark bar in the browser. Click **Add Page > Save**.
4. The e-book will automatically be returned at the end of its lending period.

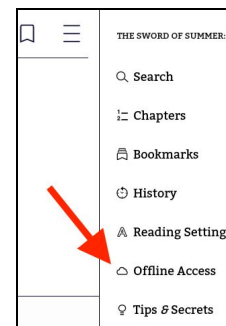

Load e-books onto your tablet, smartphone or Kindle Fire

1. Install the OverDrive app onto the device. 
This is required in order to read the e-book.
2. Open the OverDrive app, then follow these steps to set up the application. Note, you only have to do this once!
 - a. Click **Continue**.
 - b. Click **Add a Library**.
 - c. Enter "**Bristol**" in the library name field.
 - d. Scroll down and select **Bristol Elementary** which appears under the heading **Wisconsin**

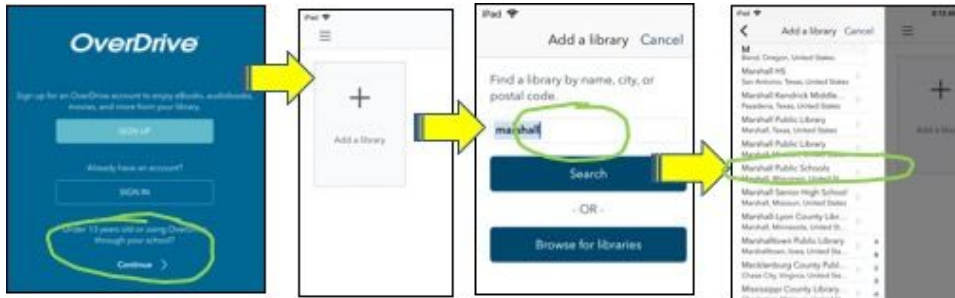

Schools Digital Library Consortium. Select carefully because there are a few Bristols.

- e. Scroll down and select **Bristol Elementary**.
 - f. Sign in. Username = lastname.fir Password = AR/STAR/Destiny password
3. Search or browse to find an e-book to read.
 - a. Search or browse to find an e-book to read.
 - b. Click book cover for more information.
 - c. Click **Borrow > Go to Checkouts > Add to app (EPUB e-book)**
 4. Select the menu (three horizontal lines) in the upper left corner of the screen to open the menu. Select **Bookshelf** from the menu.
 5. Click the cover of the book you want to read. The e-book will automatically be returned at the end of its lending period.

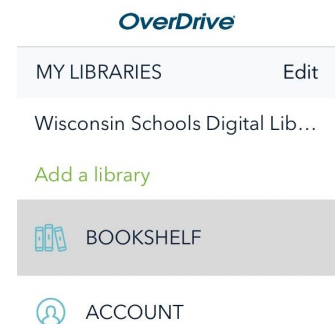

These directions will also be available on Bristol School Library's webpage. (<https://bristol.k12.wi.us> => School => Library Media Center => Overdrive